

# R48DH Series

## HIGH TORQUE POWER ROLLER (Built-in DC Brushless Motor)

R48-DH-060



**Dimension :**

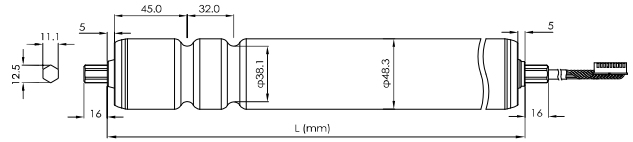

Outer Diameter: φ 48.3mm  
Power: 24VDC

Tube thickness: 1.7mm  
Tube material: STKM12

**Specification :**

Velocity (m/min)		Tangential Force (N)		Torque (N.m)		Input Current (A)			Rated Output (W)	Tube Length (L)	
No Load	Rated	Rated	Starting	Rated	Starting	No Load	Rated	Starting		mm	inch
60	60	29.0	107.6	0.7	2.6	0.6	2.5	4.0	28	380~2000	15.0~78.7

1N ≅ 0.1kg 1N.m ≅ 10kgf.cm

1. Above results were tested with WWL control card.
2. Variable speed : 33~100% (setting by WWL control card)
3. Ambient temperature : 0~40°C
4. Relative humidity : 90% RH max. (non-condensing)

※ Customized specifications are welcome, please contact us for details.  
 ※ Specifications are subject to change without prior notice.

## HIGH SPEED POWER ROLLER (Built-in DC Brushless Motor)

R48-DH-100



**Dimension :**

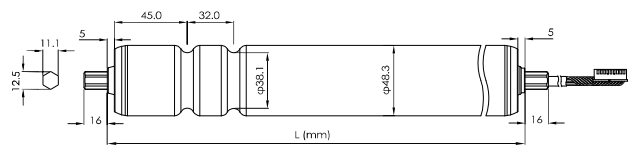

Outer Diameter: φ 48.3mm  
Power: 24VDC

Tube thickness: 1.7mm  
Tube material: STKM12

**Specification :**

Velocity (m/min)		Tangential Force (N)		Torque (N.m)		Input Current (A)			Rated Output (W)	Tube Length (L)	
No Load	Rated	Rated	Starting	Rated	Starting	No Load	Rated	Starting		mm	inch
100	100	17.4	49.7	0.42	1.2	1.0	2.3	4.0	28	360~2000	14.2~78.7

1N ≅ 0.1kg 1N.m ≅ 10kgf.cm

1. Above results were tested with WWL control card.
2. Variable speed : 33~100% (setting by WWL control card)
3. Ambient temperature : 0~40°C
4. Relative humidity : 90% RH max. (non-condensing)

※ Customized specifications are welcome, please contact us for details.  
 ※ Specifications are subject to change without prior notice.